

FACTSHEET - MPS - 296SP

Characteristics 20 ft x 9.6 ft container pontoon with spud casing

Length O.A.	6.09 m (20ft)
Breadth O.A.	2.44 m (8ft)
Depth	2.89 m (9.6ft)
Weight	11.8 ton
Deck thickness	10 mm
Spud leg diameter	762 mm
Capacity jacking system	70 ton
Watertight bulkhead	1
Compartments	2
Manholes	2
Deckload	8.0 t/m ²
T (draught) empty	0.84 m
T (draught) Max.	2.46 m
Load cap at t Max.	22.8 ton
Class society	Bureau Veritas
Class Notation	Inland waters Sheltered area Coastal area

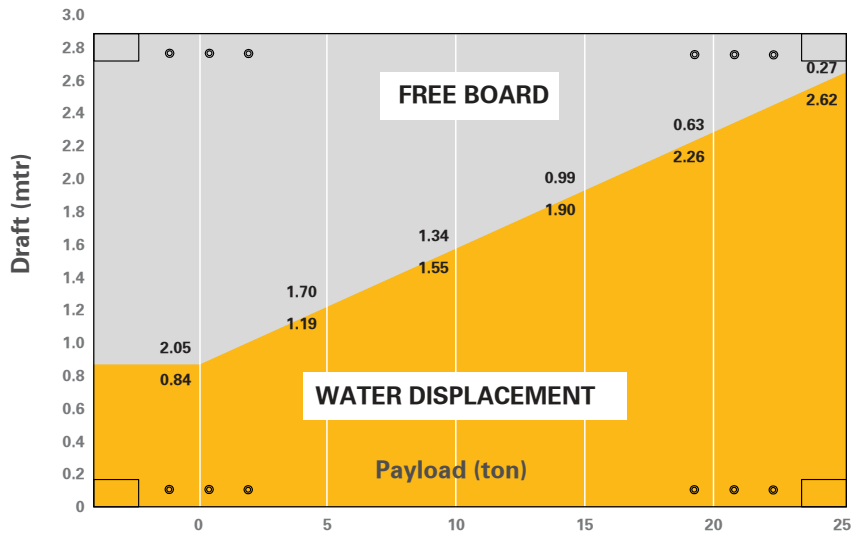

TEKLOCK®

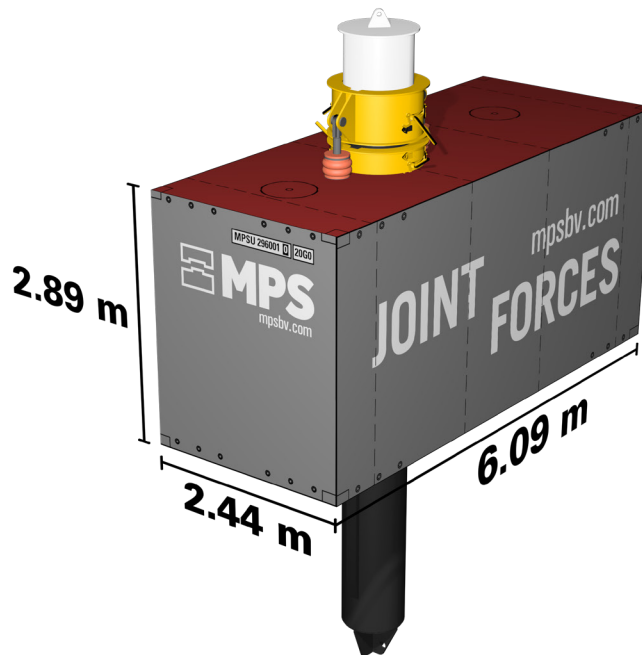
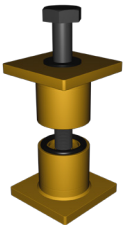

TRANSPORT OPTIONS



BY ROAD



BY SEA



BY RAIL

MPSU 296001 Q 22U1

CSC APPROVAL
 CERTIFICATE

CSC SAFETY APPROVAL	
APPROVAL REFERENCE	
DATE MANUFACTURED	
IDENTIFICATION No.	
MAXIMUM OPERATING GROSS MASS	kg / lbs
ALLOWABLE STACKING LOAD FOR 1.8 g	kg / lbs
TRANSVERSE RACKING TEST FORCE	newtons
END WALL STRENGTH	kg / NIL / lbs
SIDE WALL STRENGTH	kg / NIL / lbs
NEXT EXAMINATION DATE	/ /