

FACTSHEET - MPS - 280SP

Characteristics 20 ft x 8 ft container pontoon with spud casing

Length O.A.	6.09 m (20ft)
Breadth O.A.	2.44 m (8ft)
Depth	2.44 m (8ft)
Transport height	3.18 m
Weight	10.2 ton
Deck thickness	8 mm
Spud leg diameter	762 mm
Capacity jacking system	70 ton
Watertight bulkhead	1
Compartments	2
Manholes	2
Deckload	6.0 t/m ²
T (draught) empty	0.71 m
T (draught) Max.	2.14 m
Load cap at t Max.	20.5 ton
Class society	Bureau Veritas
Class Notation	Inland waters Sheltered area Coastal area

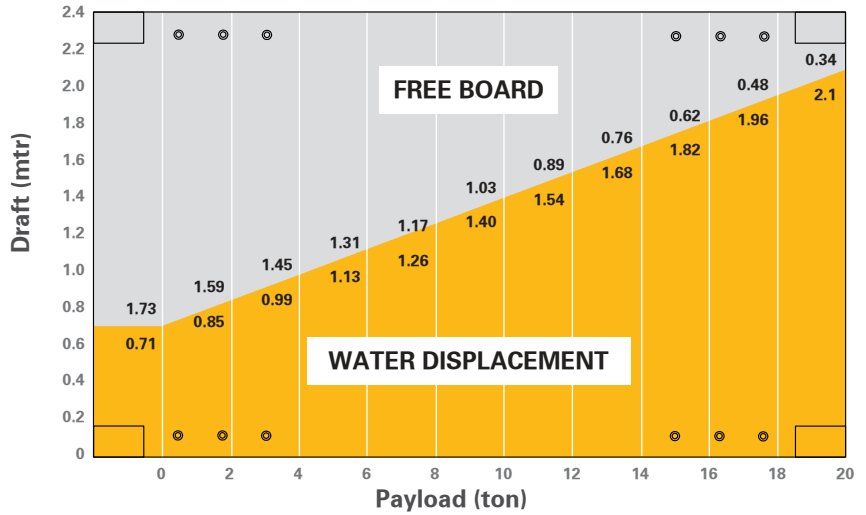

TEKLOCK®

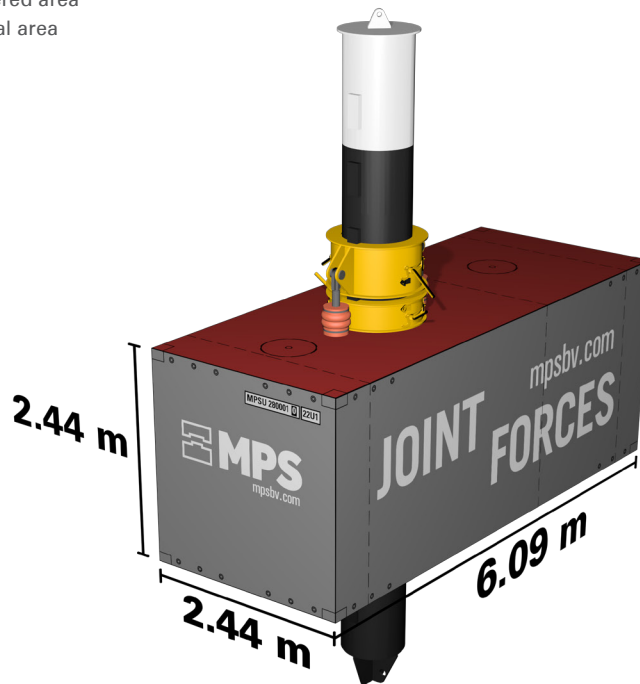
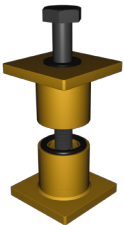

TRANSPORT OPTIONS



BY ROAD



BY SEA



BY RAIL

MPSU 280001 0 20G0

CSC APPROVAL
 CERTIFICATE

CSC SAFETY APPROVAL			
APPROVAL REFERENCE			
DATE MANUFACTURED			
IDENTIFICATION No.			
MAXIMUM OPERATING GROSS MASS	kg		lbs
ALLOWABLE STACKING LOAD FOR 1.8 g	kg		lbs
TRANSVERSE RACKING TEST FORCE	newtons		
END WALL STRENGTH	kg	NIL	lbs
SIDE WALL STRENGTH	kg	NIL	lbs
NEXT EXAMINATION DATE			